

TIGERLION®

Established in 1995, Ningbo Nisten Enterprise Co., Ltd, is a professional manufacturer of a full line of industrial brushes, polishing wheels, and grinding wheels as well as cleaning tools. Benefiting from advantageous location, our factory is just 70km outside of the Ningbo Airport and 2 and half hours by car far away from Shanghai.

With modern equipment, a 13,000 square meters workshop, and 120 persons, our company always offers superior products at competitive prices. Under modern management, our entire manufacturing process is compliant with ISO9002 quality control stipulations. As a result, we can ensure consistently high product quality. The range and flexibility of our production processes mean that we are in a position to comply with any customer requirements.

We continually concentrate our efforts on attracting and maintaining world-class talent, producing high quality products and above all delivering customer satisfaction. We sincerely welcome customers both domestic and abroad to cooperate with us to develop rewarding business partnerships.





In order to obtain our world renowned wire quality we are always in touch with internationally chosen wire manufacturers and they are in the position to offer you a wide variety of wire qualities for all kinds of applications.

The most important characteristic for the quality of brush wire is the tensile strength which determines the abrasion-proof, hardness and cutting duty of the wire brush.

The list besides retails the wire are most frequently used today and the table above informs you about their chemical and physical qualities. The indications of the tensile strength refer to a medium wire diameter of 0.33mm where as thinner wire exceed these values by 10 per cent max.



And thicker diameters hover around 10 per cent max. And thicker diameters hover around 10 per cent less. Please also consider that these tensile strength values result from tests with straight wires which means that for crimped wires they can be produced by up to 10 per cent according to the crimp.



5 - this round filament with integrated silicon carbide [sic] or oxide aluminium [al₂o₃] grits are used worldwide. We offer grit sizes from 46 to 800. heat stability, a considerable chemical resistance.

Our basic quality is principally composed of heat resistant basic Nylon material [including types from PA 6 up to PA 6.12 and a grit per cent of 20 to 40.]

Abrasive filaments are especially appropriate for deburring processes and surface treatment of steel, heavy metals, aluminium or even wood.



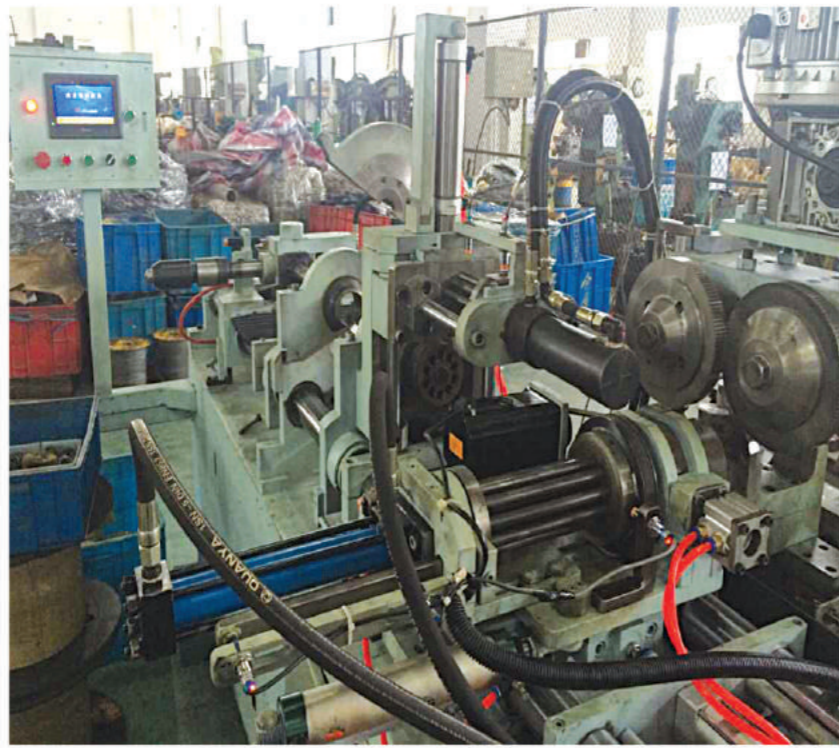
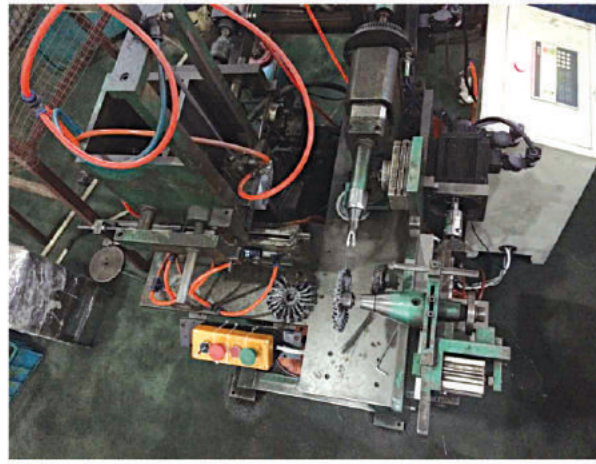

POWER BRUSHES:TERMINOLOGY

Outside Diameter

The overall diameter of the brush. To provide the most efficient use and lowest end-of-service cost, always use the largest diameter brush practical. Radial brushes used on portable tools should not be larger than six inches in diameter.

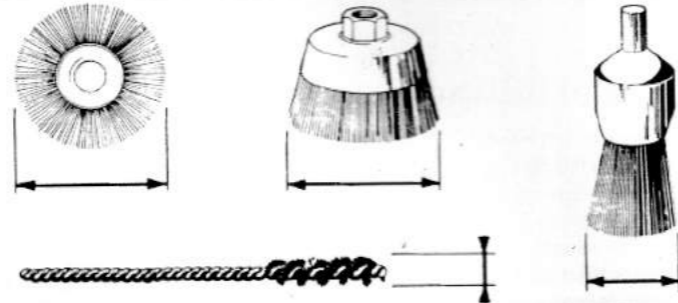

Trim Length

The length of the fill material extended beyond the Brush back or flange. A short trim length provides a stiff, fast cutting brush. A long trim length provides flexibility-for brushing irregular surfaces-and a softer brushing action.

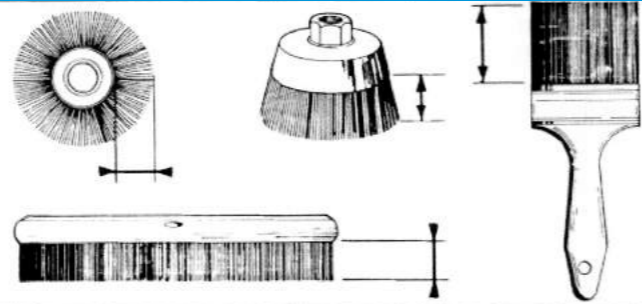

Arbor Hole

The actual diameter of the mounting hole in the brush. Various arbor holes and adapters are available to accommodate the shaft sizes used on different type of motor drives.

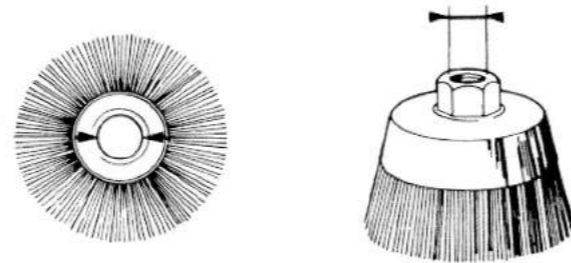

Operating Face Width

The width of the brush face when the brush is under power. Wide face brushes cover a larger working area and are usually stiffer acting than narrow face brushes are used individually to brush confined areas. They are also used in multiples to provide greater width and to eliminate streaking.

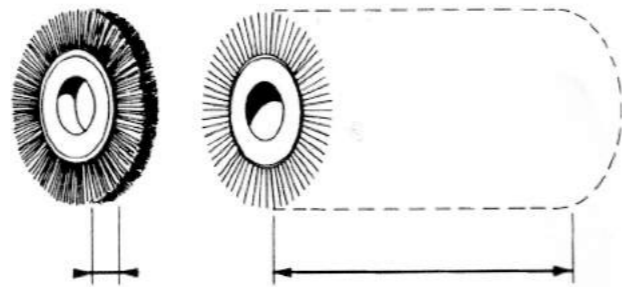

Brush Length

The length of the fill material in end and tube type brushes.

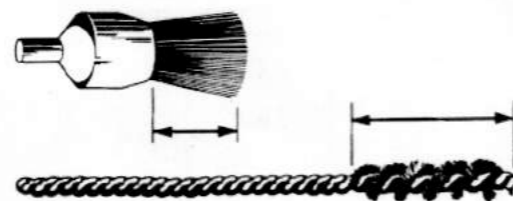

Table Of peripheral Speeds m/sec:

Peripheral speed is a decisive factor in achieving optimum performance from a brush, the table opposite will enable you to determine the relevant peripheral speed by simply reading down and across the appropriate diameter and drive shaft operating Speed columns. Please note; The operating speed should never exceed the Maximum RPM ratings for each brush as show in this catalogue. In case where maximum RPM ratings are not indicated and for special brushes which are not listed contact our technical department for guidance. The maximum RPM ratings are safety ratings not recommended operating speeds. The optimum operating speed is determined by the application and in most cases lower operating speeds will prove more efficient and achieve the best result.

As a general guide we recommend the following peripheral speed when working on the materials listed with:

- Steel-approx. 30m/sec.
- Non-ferrous metals 18-20m/sec.
- Plastic-approx. 15m/sec.
- Teisted wire steel
- Abrasive filaments
- Steel 18-20m/sec.
- Non-ferrous metls 18-20m/sec.
- Plastic-approx. 15m/sec.

What to do if the desired brushing effect is not obtained; Brushing effect too weak

- Increase the peripheral speed by increasing the brush diameter or the operating speed but never exceed the maximum RPM rating.
- Decrease the trim length.
- Increase the diameter of the fill material

Brushing effect too powerful:

- Reduce the peripheral speed by reducing the brush diameter or the operating speed.
- Increase the trim length
- Decrease the diameter of the fill material

Surface finish too smooth:

- Increase the peripheral speed by increasing the brush diameter or the operating speed but never exceed the maximum RPM rating.
- Decrease the trim length.

Surface finish too smooth:

- Reduce the peripheral speed by reducing the brush diameter or the operating speed.
- Increase the diameter of the fill material.

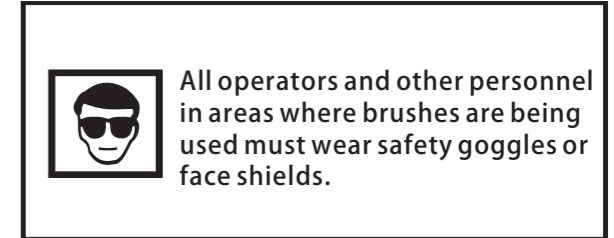
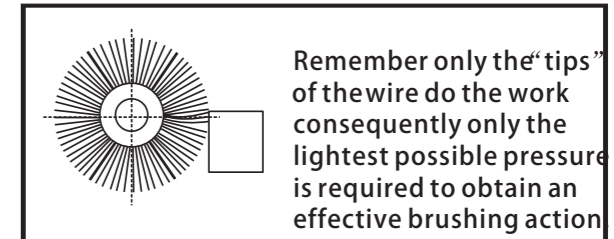
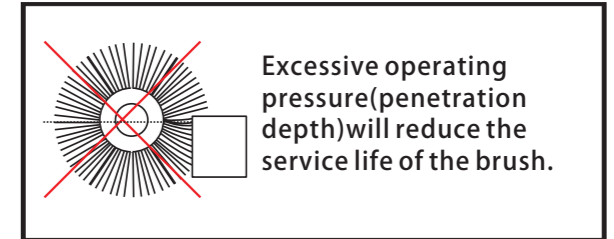

Peripheral Speed m/sec	Brush diameter in mm.											
	40	50	80	100	125	150	180	200	250	300	350	
800			3.35	4.19	5.23	6.28	7.53	8.38	10.47	12.56	14.75	
900		2.35	3.77	4.71	5.88	7.06	8.48	9.41	11.77	14.12	16.47	
1.150		3.01	4.81	6.01	7.52	9.02	10.83	12.03	15.04	18.04	21.04	
1.200	1.26	2.51	3.14	5.02	6.28	7.85	9.41	11.30	12.55	15.69	18.83	
1.400	1.46	2.93	3.66	5.86	7.32	9.15	10.98	13.18	14.64	18.31	21.97	
1.500	1.57	3.14	3.92	6.28	7.85	9.81	11.77	14.13	15.69	19.61	23.54	
1.800	1.88	3.77	4.71	7.54	9.41	11.77	14.12	16.95	18.83	23.54	28.24	
2.000	2.09	4.19	5.23	8.37	10.26	13.08	15.69	18.84	20.92	26.15	31.38	
2.500	2.62	5.23	6.54	10.47	13.08	16.35	19.61	23.55	26.15	32.67	39.23	
2.800	2.93	5.86	7.32	11.72	14.64	18.31	21.97	26.37	29.29	36.61	43.93	
3.000	3.14	6.28	7.85	12.56	15.69	19.62	23.54	28.26	31.38	39.23	47.07	
3.200	3.35	6.70	8.37	13.40	16.74	20.92	25.10	30.14	33.47	41.84	50.21	
3.500	3.66	7.33	9.15	14.65	18.31	22.89	27.46	32.97	36.61	45.76	54.92	
4.000	4.19	8.37	10.46	16.75	20.93	26.16	31.38	37.68	41.84	52.33	62.76	
4.500	4.70	9.42	11.77	18.84	23.94	29.43	35.30	42.40	47.07	58.84	70.61	
5.000	5.23	10.47	13.08	20.94	26.15	32.70	39.23	47.10	52.33	65.38	78.50	
5.400	5.65	11.30	14.12	22.04	28.24	35.31	42.36	50.67	56.48	70.61	84.78	
6.000	6.28	12.56	15.69	25.12	31.38	39.24	47.07	56.62	62.76	78.50		
7.000	7.33	14.66	18.31	29.31	36.61	45.78	51.92	65.94	73.22	91.58		
8.000	8.37	16.75	20.92	33.94	41.48	52.32	62.76	75.36	83.73			
9.000	9.42	18.84	23.54	37.68	47.07	58.86	70.61	84.78	94.20			
10.000	10.47	20.93	26.17	41.86	52.33	65.40	78.50	94.20				
12.500	13.08	26.17	32.71	52.33	65.42	81.75	98.13					
15.000	15.70	31.40	39.25	62.80								
17.500	18.32	36.63	45.79	73.26								
20.000	20.93	41.87	52.33	83.73								
22.500	23.55	47.10	58.55	94.20								
25.000	26.17	52.33	65.42	104.66								

Contents

PROFESSIONAL KNOTTED CUP BRUSH	10
PROFESSIONAL CRIMPED WHEEL BRUSH	11
PROFESSIONAL SHAFTE WHEEL BRUSH	11
BEVEL BRUSHES	12
KNOTTED WHEEL BRUSHES WITH SHANK	12
PROFESSIONAL COPPER CENTER BRUSH	13
PROFESSIONAL KNOTTED END BRUSH	14
THREADS14CRIMPED WIRE WHEEL BRUSHES-WIDE	15
CRIMPED WIRE WHEEL BRUSHES-THIN	15
KNOTTED TWIST WHEEL BRUSHES	16
STRINGER KNOTTED WHEEL BRUSHES	16
CRIMPED WIRE CUP BRUSHES	17
KNOTTED TWIST CUP BRUSHES	18
SHAFT-MOUNTED WHEEL BRUSHES	19
SHAFT-MOUNTED CUP BRUSHES	19
CRIMPED WIRE END BRUSHES	20
KNOTTED BRUSHES WITH SHANK	20
BEVEL BRUSHES	21
ABRASIVE WHEEL BRUSHES	23
ABRASIVE CUP BRUSHES	23
SHAFT MOUNTED ABRASIVE WHEEL BRUSHES	23
STRIP FLAT BRUSH	23
SHAFT-MOUNTED ABRASIVE WHEEL BRUSHES	24
SHAFT-MOUNTED CUP ABRASIVE BRUSHES	24
ABRASIVE TUBE BRUSH	24
BLISTER CARD D.I.Y BRUSH SET	25
DISC BRUSHES	26
KNIFE-SHAPE PLASTIC HANDLE BRUSH	27
MINI HAND SCRATCH BRUSH WITH WIRE HANDLE	27
WOODEN HANDLE BRUSH	28
PLASTIC HANDLE SCRATCH BRUSH	28
WOODEN HANDLEBRUSH	28
TUBE BRUSHES	29
FILE BRUSH	30
PIPE FITTING CLEANING BRUSH	30
FLEX HONE	31
MULTI-PURPOSE TUBE BRUSH	31
BATTERY TERMINAL BRUSH	31
MUNIATURE BRUSHES	32
PVC HOLDER DOOR SEAL BRUSH	33
ALUMINIUM HOLDER DOOR SEAL BRUSH	34
ALUMINIUM HOLDER FLEXIBLE PVC FELT	35
FLEXIBLE PVC FELT	36
LETTER BOX PLATE	37
SEALING BRUSHES	38



PROFESSIONAL HIGH SPEED KNOTTED WIRE CUP BRUSH

Type	∅	R.P.M.max.	Fill types	QTY.Pack	Dimension
Art No	Mm		Mm	Pcs	cm
61875	75	14000	0.35/0.5	24	60x24x28 Double blister
61100	100	8500	0.35/0.5	24	70x23x31 Double blister
61125	125	8000	0.35/0.5	24	63x32x36 Double blister

Threads and Arbor hole:

Thread: M10x1.25
M10x1.5
M14x2
5/8" -11
Arbor hole: 1/2" (12.7mm)
5/8" (15.8mm)
3/4" (19mm)
7/8" (22.2mm)



PROFESSIONAL HIGH SPEED HEAVY KNOTTED WIRE CUP BRUSH

Type	∅	R.P.M.max.	Fill types	QTY.Pack	Dimension
Art No	Mm		Mm	Pcs	cm
63865	65	12500	0.35/0.5	100	40x33x32
63100	100	7000	0.35/0.5	36	42x32x27
63125	125	6500	0.35/0.5	24	41x28x36

Threads and Arbor hole:

Thread: M10x1.25
M10x1.5
M14x2
5/8" -11
Arbor hole: 1/2" (12.7mm)
5/8" (15.8mm)
3/4" (19mm)
7/8" (22.2mm)



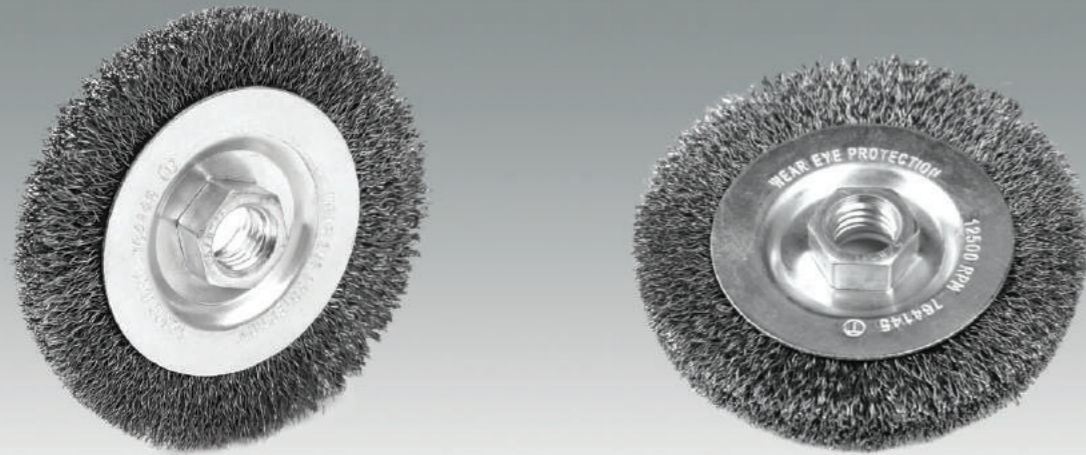

PROFESSIONAL HIGH SPEED CRIMPED WIRE WHEEL BRUSH

Type	φ	R.P.M.max.	Fill types	QTY.Pack	Dimension
Art No	Mm		Mm	Pcs	cm
65100	100	12500	0.3/0.35/0.5	60	46x36x18



PROFESSIONAL SHAFT--MOUNTED WIRE WHEEL BRUSH--WIDE

Type	φ	S H B	R.P.M.max.	Fill types	QTY.Pack	Dimension
Art No	Mm	Mm		Mm	Pcs	cm
66880	80	8x27x35	4500	3 in 1 wire 0.3	60	41x38x38
66100	100	8x27x35	4500	3 in 1 wire 0.3	60	46x38x38

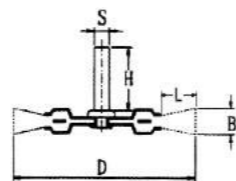

Threads and Arbor hole:

Thread: M10x1.25
M10x1.5
M14x2
5/8" -11
Arbor hole: 1/2" (12.7mm)
5/8" (15.8mm)
3/4" (19mm)
7/8" (22.2mm)

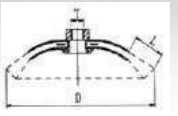
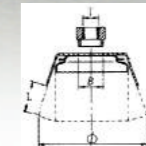

BEVEL BRUSHES

Type	Shape	D	B	R.P.M.max.	Fill types	Making way	QTY.Pack	Dimension
Art No		Mm	mm		Mm		Pcs	cm
TG-7175	cup	75	20	12000	0.3/0.35	Knotted	80	46x24x45
TG-7285	bevel	85	20	12000	0.3/0.35	Crimped	80	46x24x45
TG-72100	bevel	100	20	8000	0.3/0.35	Crimped	60	41x27x53
TG-72125	bevel	125	20	8000	0.35/0.5	Crimped	42	41x27x51

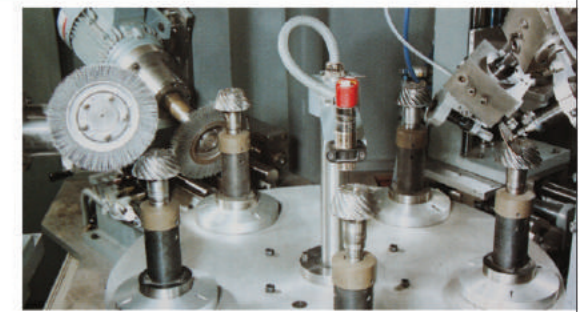

Fill types:

- S** steel wire, natural hard, crimped
- ST** Steel wire, straight
- SS** Stainless steel wire, acid resistant, crimped or knotted
- B** Brass wire, crimped
- BS** Brass plated steel wire, crimped
- A** Abrasive filaments, silicon carbide, or oxide aluminium crimped, grit sizes: 80-320

Applications:

Removal of rust, corrosion, paint and primer and generally to produce clean surface.



KNOTTED WHEEL BRUSHES WITH SHANK

Type	D	S	R.P.M.max.	Fill types	Brush shape
Art No	Mm	mm		Mm	
96850A	50	6	12500	0.35/0.5	Wheel
96875A	75	6	12500	0.35/0.5	Wheel
96100A	100	6	12500	0.35/0.5	Wheel

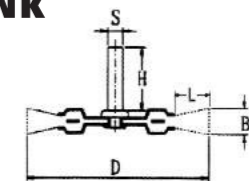

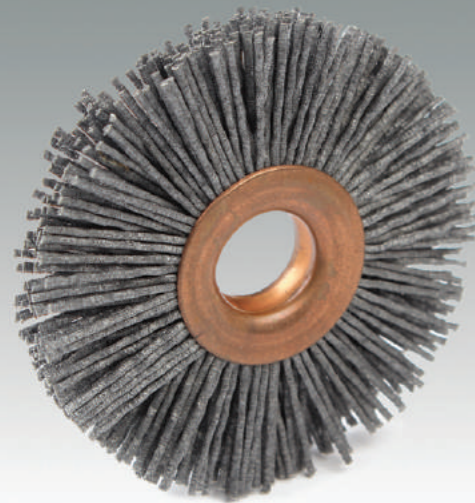

Arbor hole:

- 6mm
- 7mm
- 9.5mm
- 13mm
-
- anymore size can be customized



PROFESSIONAL COPPER CENTER BRUSH-ABRASIVE

Type	φ	Fill types
Art No	Mm	Mm
69850A	50	AO/SIC
69863A	63	AO/SIC
69875A	75	AO/SIC
69100A	100	AO/SIC

PROFESSIONAL COPPER CENTER BRUSH-STEEL

Type	φ	Fill types
Art No	Mm	Mm
69850	50	0.2/0.3/0.35
69863	63	0.2/0.3/0.35
69875	75	0.2/0.3/0.35
69100	100	0.2/0.3/0.35



PROFESSIONAL SHAFT--MOUNTED WHEEL WIRE BRUSH--WIDE

Type	φ	S H B	R.P.M.max.	Fill types	QTY.Pack	Dimension
Art No	Mm	Mm		Mm	Pcs	cm
64875	75	6x27x16	4500	0.3/0.35	60	41x38x38
64100	100	6x27x16	4500	0.3/0.35	60	46x38x38

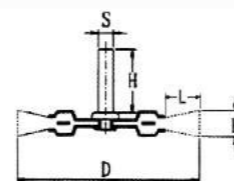

CRIMPED WIRE WHEEL BRUSHE

Type	φ	d	B	Fill types
Art No	Mm	Mm	Mm	Mm
60120A	120	19	100	ao/sic
60120S	120	19	100	steel
60120	120	19	100	nylon fiber



PROFESSIONAL KNOTTED END BRUSH

Type	φ	S H	R.P.M.max.	Fill types
Art No	Mm	Mm		Mm
98819A	19	6X18	20000	0.35/0.5
98822A	22	6X18	20000	0.3/0.35
98825A	25	6X18	20000	0.3/0.35
98830A	30	6X18	20000	0.3/0.35

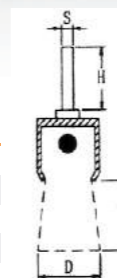

- TA-M14X2
- TA-M10X1.5
- TA-M10X1.25
- TA-5/8-11
- TB-M14X2
- TB-5/8-11
- TC-M14X2
- TC-5/8-11



7150



Plastic adapters for brush dia 100 and 125mm (1/2" , or 3/8")
brush dia 150-300mm (1/2" , 5/8" , 3/4" , 7/8" , 1" , 1 1/4"



CRIMPED WIRE WHEEL BRUSHES-WIDE

Type	D	B	L	R.P.M.max.	Fill types	QTY.Pack	Dimension
Art No	Mm	mm	mm		Mm	Pcs	cm
93875	75	14	20	8000	0.20/0.30/0.35/0.4	60	46x36x18
93100	100	16	20	6000	0.20/0.30/0.35/0.4	60	46x36x18
93125	125	18	32	6000	0.20/0.30/0.35/0.4	42	42x29x26
93150	150	22	32	6000	0.20/0.30/0.35/0.4	32	35x34x31
93175	175	22	32	6000	0.20/0.30/0.35/0.4	20	38x19x36
93200	200	25	32	4500	0.20/0.30/0.35/0.4	20	44x23x39
93250	250	25	32	4500	0.20/0.30/0.35/0.4	12	56x29x22.5
93300	300	25	32	4500	0.20/0.30/0.35/0.4	10	65x32.5x21

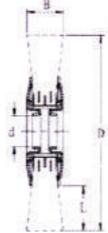

KNOTTED TWIST WHEEL BRUSHES

Type	Ø	B	d	R.P.M.max.	Fill types	QTY.Pack	Dimension
Art No	Mm	mm	Mm		Mm	Pcs	cm
92875	75	13	13	20000	0.35/0.5	60	46x36x18
92100	100	11	22.2	11000	0.35/0.5	60	46x36x18
92125	125	11	22.2	11000	0.35/0.5	42	49x29x26
92150	150	12	22.2	9000	0.35/0.5	32	35x34x31
92175	175	15	22.2	9000	0.35/0.5	20	38x19x36
92200	200	15	22.2	6000	0.35/0.5	20	38x19x36

Threads and Arbor hole:

- Thread: M10x1.25
M10x1.5
M14x2
5/8" -11
- Arbor hole: 1/2" (12.7mm)
5/8" (15.8mm)
3/4" (19mm)
7/8" (22.2mm)

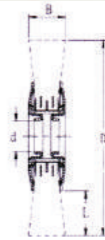

Fill types:

- S** steel wire, natural hard, crimped
 - ST** Steel wire, straight
 - SS** Stainless steel wire, acid resistant, crimped or knotted
 - B** Brass wire, crimped
 - BS** Brass plated steel wire, crimped
- A** Abrasive filaments, silicon carbide, or oxide aluminium crimped, grit sizes: 80-320

Applications:

Removal of rust, corrosion, paint and primer and generally to produce clean surface.

CRIMPED WIRE WHEEL BRUSHES-THIN

Type	D	B	D	R.P.M.max.	Fill types	QTY.Pack	Dimension
Art No	Mm	mm	mm		Mm	Pcs	cm
20197875	75	10	13	4500	0.20/0.30/0.35	60	46x36x18
20197100	100	10	16	4500	0.20/0.30/0.35	60	46x36x18
20197125	125	13	22.2	4500	0.20/0.30/0.35	42	49x29x26
20197150	150	13	25	4500	0.20/0.30/0.35	32	35x34x31
20197175	175	13	32	4500	0.20/0.30/0.35	20	38x19x36
20197200	200	13	32	4500	0.20/0.30/0.35	20	38x19x36

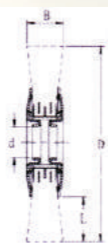

STRINGER KNOTTED WHEEL BRUSHES

With thread or arbor hole.

C.type	Ø	B	d	R.P.M.max.	Fill types	QTY.Pack	Dimension
Art No	Mm	mm	Mm		Mm	Pcs	cm
92100C	100	6	22.2	11000	0.35/0.5	60	46x36x18
92125C	125	6	22.2	11000	0.35/0.5	42	42x29x26
92178C	178	6	22.2	9000	0.35/0.5	20	38x19x36

Threads and Arbor hole:

- Thread: M10x1.25
M10x1.5
M14x2
5/8" -11
- Arbor hole: 1/2" (12.7mm)
5/8" (15.8mm)
3/4" (19mm)
7/8" (22.2mm)

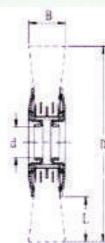



CRIMPED WIRE CUP BRUSHES

Type	φ	B	L	R.P.M.max.	Fill types	QTY.Pack	Dimension
Art No	Mm	mm	mm		Mm	Pcs	Cm
99865	65	16	20	12500	0.2/0.3/0.35/0.4	100	40X33X32
99875	75	16	27	12500	0.2/0.3/0.35/0.4	80	43X34X31
99885	85	22.2	27	8500	0.2/0.3/0.35/0.4	36	36.5X27X25
99100	100	22.2	29	8500	0.2/0.3/0.35/0.4	36	42X32X27
99125	125	22.2	33	6500	0.2/0.3/0.35/0.4	24	41X28X36
99150	150	22.2	33	4500	0.2/0.3/0.35/0.4	18	46X30.5X29

Threads and Arbor hole:

Thread: M10x1.25
M10x1.5
M14x2
5/8" -11
Arbor hole: 1/2" (12.7mm)
5/8" (15.8mm)
3/4" (19mm)
7/8" (22.2mm)

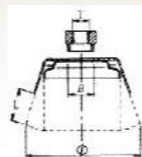

Fill types:

S steel wire, natural hard, crimped
ST Steel wire, straight
SS Stainless steel wire, acid resistant, crimped or knotted
B Brass wire, crimped
BS Brass plated steel wire, crimped

A Abrasive filaments, silicon carbide, or oxide aluminium crimped, grit sizes: 80-320

Applications:

Removal of rust, corrosion, paint and primer and generally to produce clean surface.

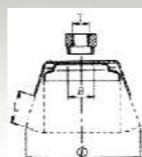

CRIMPED WIRE CUP BRUSHES

A.type	φ	B	L	R.P.M.max.	Fill types	QTY.Pack	Dimension
Art No	Mm	mm	mm		Mm	Pcs	Cm
99875A	75	16	27	12500	0.30/0.35	80	43X34X31
99100A	100	22.2	29	8500	0.30/0.35	36	42X32X27
99125A	125	22.2	33	6500	0.30/0.35	24	41X28X36

Threads and Arbor hole:

Thread: M10x1.25
M10x1.5
M14x2
5/8" -11
Arbor hole: 1/2" (12.7mm)
5/8" (15.8mm)
3/4" (19mm)
7/8" (22.2mm)



KNOTTED TWIST CUP BRUSHES

B.type	φ	B	R.P.M.max.	Fill types	QTY.Pack	Dimension
Art No	Mm	mm		Mm	Pcs	cm
91865B	65	20	12500	0.35/0.5	100	40x33x32
91875B	75	25	12500	0.35/0.5	80	43x34x31
91880B	80	25	8500	0.35/0.5	36	36.5x27x25
91890B	90	25	8500	0.35/0.5	36	42x32x27
91100B	100	25	8500	0.35/0.5	36	42x32x27
91125B	125	25	6500	0.35/0.5	24	41x28x36
91150B	150	22.2	4500	0.3/0.35	18	46x30.5x29

Threads and Arbor hole:

Thread: M10x1.25
M10x1.5
M14x2
5/8" -11
Arbor hole: 1/2" (12.7mm)
5/8" (15.8mm)
3/4" (19mm)
7/8" (22.2mm)

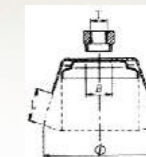

KNOTTED TWIST CUP BRUSHES

A.type	D	B	L	R.P.M.max.	Fill types	QTY.Pack	Dimension
Art No	Mm	mm	mm		Mm	Pcs	cm
91865A	65	20		12500	0.35/0.5	100	40x33x32
91880A	80	25	22.2	8500	0.35/0.5	36	41x34x31
91890A	90	25	22.2	7000	0.35/0.5	36	43x34x30
91100A	100	25	22.2	7000	0.35/0.5	36	42x32x27
91125A	125	25	22.2	6500	0.35/0.5	24	41x28x36

Threads and Arbor hole:

Thread: M10x1.25
M10x1.5
M14x2
5/8" -11
Arbor hole: 1/2" (12.7mm)
5/8" (15.8mm)
3/4" (19mm)
7/8" (22.2mm)

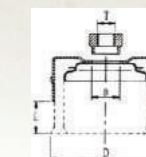



SHAFT-MOUNTED WHEEL BRUSHES

Type	D	B	S	R.P.M.max.	Fill types	QTY.Pack	Dimension
Art No	Mm	mm	mm		Mm	Pcs	cm
96838	38	5	6	4500	0.2/0.3/0.35/0.4	270	59x35x36
96850	50	7	6	4500	0.2/0.3/0.35/0.4	270	59x35x36
96863	63	9	6	4500	0.2/0.3/0.35/0.4	270	59x35x36
96875	75	10	6	4500	0.2/0.3/0.35/0.4	180	59x35x36
96100	100	12	6	4500	0.2/0.3/0.35/0.4	80	57x31x42

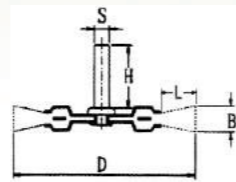

CRIMPED WIRE END BRUSHES

Type	D	L	S	R.P.M.max.
Art No	Mm	mm	mm	
98812	12	20	6	4500
98817	17	22	6	4500
98822	22	25	6	4500
98825	25	25	6	4500
98830	30	25	6	4500

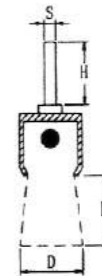

SHAFT-MOUNTED CUP BRUSHES

Type	D	B	L	S	R.P.M.max.	Fill types	QTY.Pack	Dimension
Art No	Mm	mm	mm	mm		Mm	Pcs	cm
95840	40	10	15	6	4500	0.30/0.35	216	56x35x33
95850	50	10	20	6	4500	0.30/0.35	216	56x35x33
95860	60	15	20	6	4500	0.30/0.35	120	56x35x33
95875	75	15	25	6	4500	0.30/0.35	96	56x35x33
95880	80	15	25	6	4500	0.30/0.35	96	56x35x33

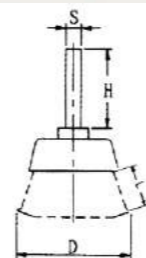

KNOTTED BRUSHES WITH SHANK

Type	D	S	R.P.M.max.	Fill types	Brush shape
Art No	Mm	mm		Mm	
95850A	50	6	12500	0.35/0.5	Cup
95875A	75	6	12500	0.35/0.5	Cup
7003B	75	6	12500	0.35/0.5	Bevel

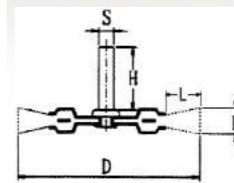
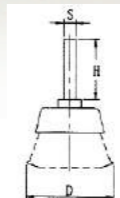



BEVEL BRUSHES

Type	D	B	R.P.M.max.	Fill types	Making way	QTY.Pack	Dimension
Art No	Mm	mm		Mm		Pcs	cm
7001	85	20	8500	0.3/0.35	Crimped	80	46x24x45
7002	100	20	8500	0.3/0.35	Crimped	60	46x24x45
7003	125	20	8500	0.3/0.35	Crimped	42	41x27x51
89100	100	20	11000	0.35/0.5	Knotted	60	46x24x45
89115	115	27.5	11000	0.35/0.5	Knotted	42	41x27x51

Threads and Arbor hole:

Thread: M10x1.25
 M10x1.5
 M14x2
 5/8" -11
 Arbor hole: 1/2" (12.7mm)
 5/8" (15.8mm)
 3/4" (19mm)
 7/8" (22.2mm)

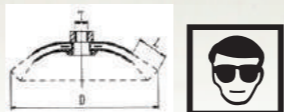

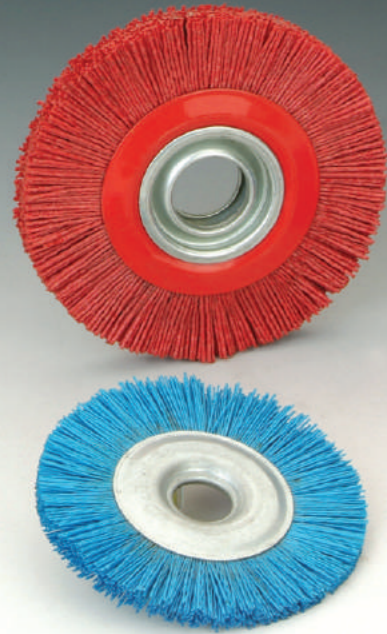

Threads and Arbor hole:
 Thread: M10x1.25
 M10x1.5
 M14x2
 5/8" -11
 Arbor hole: 1/2" (12.7mm)
 5/8" (15.8mm)
 3/4" (19mm)
 7/8" (22.2mm)



ABRASIVE WHEEL BRUSHES

Type	φ	B	L	R.P.M.max.	Fill types	QTY.Pack	Dimension
Art No	Mm	mm	Mm			Pcs	cm
88875	75	9	27	4500	AO/SiC	60	47x35x19
88100	100	13	29	4500	AO/SiC	60	47x35x19
88125	125	13	33	4500	AO/SiC	42	49x29x26
88150	150	19	29	4500	AO/SiC	32	35x34x31
88175	175	25	38	4500	AO/SiC	20	38x19x36
88200	200	25	38	4500	AO/SiC	20	38x19x36

ABRASIVE CUP BRUSHES

Type	φ	B	L	R.P.M.max.	Fill types	QTY.Pack	Dimension
Art No	Mm	mm	Mm			Pcs	cm
99875D	75	16	27	12500	AO/SiC	80	46x34x32
99100D	100	22.2	29	8500	AO/SiC	36	43x34x30
99125D	125	22.2	33	4500	AO/SiC	24	41x28x40



Fill types:
S steel wire, natural hard, crimped
ST Steel wire, straight
SS Stainless steel wire, acid resistant, crimped or knotted
B Brass wire, crimped
BS Brass plated steel wire, crimped
A Abrasive filaments, silicon carbide, or oxide aluminium crimped, grit sizes: 80-320

Applications:
 Removal of rust, corrosion, paint and primer and generally to produce clean surface.

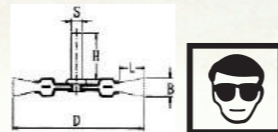

SHAFT MOUNTED ABRASIVE WHEEL BRUSHES

Type	φ	B	F	S	R.P.M.max.	Fill types
Art No	Mm	mm	Mm	Mm		
83050	50	35	45	6	4500	AO/SiC
83060	60	35	45	6	4500	AO/SiC
83075	75	40	45	6	4500	AO/SiC
83085	85	40	45	6	4500	AO/SiC
83100	100	40	45	6	4500	AO/SiC

STRIP FLAT BRUSH

Type	φ	L	D	R.P.M.max.	Fill types
Art No	Mm	mm	mm		
22100	100	100	6	4500	AO
23100	100	100	6	4500	SIC

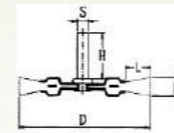

SHAFT-MOUNTED ABRASIVE WHEEL BRUSHES

A.type	D	B	L	S	R.P.M.max.	Fill types	QTY.Pack	Dimension
Art No	Mm	mm	mm	mm			Pcs	cm
86838	38	7	10	6	4500	AO/SiC	270	59x35x36
86850	50	9	10	6	4500	AO/SiC	270	59x35x36
86863	63	9	13	6	4500	AO/SiC	270	59x35x36
86875	75	10	16	6	4500	AO/SiC	180	59x35x36
86100	100	12	22	6	4500	AO/SiC	120	56x30x41

SHAFT-MOUNTED ABRASIVE CUP BRUSHES

Type	D	B	L	S	R.P.M.max.	Fill types	QTY.Pack	Dimension
Art No	Mm	mm	mm	mm			Pcs	cm
85840	40	10	15	6	4500	AO/SiC	216	47x33x35
85850	50	10	20	6	4500	AO/SiC	216	47x33x35
85860	60	15	20	6	4500	AO/SiC	120	61x39x27
85875	75	15	25	6	4500	AO/SiC	96	56x36x33
85880	80	15	25	6	4500	AO/SiC	96	56x36x33



ABRASIVE TUBE BRUSH

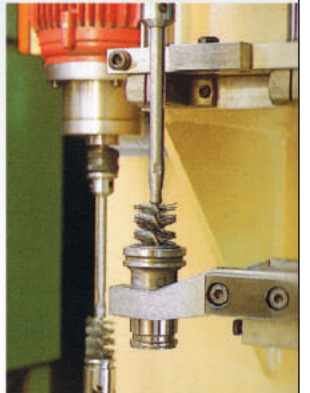
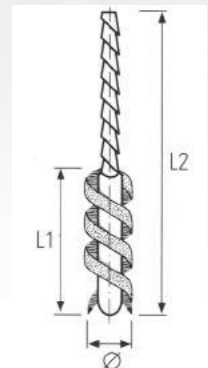

BLISTER CARD D.I.Y BRUSH SET



8003A 1 cup 75mm
1 end 25mm
1 scratch
26set 43x43x31cm 16/18kg



8003B 1 cup 75mm
1 wheel 75mm
1 scratch
26set 43x43x31cm 16/18kg



8240 1 wheel 60mm
1 wheel 75mm
1 cup 75mm
1 cup 50mm
1 end 25mm
26set 43x43x31cm 16/18kg



8220 1 wheel 75mm
1 wheel 60mm
1 wheel 50mm
1 cup 50mm
2 wheel 40mm
26set 43x43x31cm 16/18kg



9210 1 cup 75mm
1 wheel 100mm
50set 72x42x31cm 16/18kg



8230 1 cup 50mm
1 end 25mm
1 wheel 50mm
80set 58x31x42cm 20/22kg



C9003 1 wheel 75mm
1 wheel 65mm
1 wheel 50mm
50set 72x42x31cm 16/18kg



8262 1 wheel 75mm
1 wheel 50mm
1 end 25mm
1 cup 50mm
1 tube 16mm
26set 43x43x31cm 16/18kg



A9001 1 wheel 75mm
1 wheel 60mm
1 wheel 50mm
1 wheel 40mm
1 wheel 25mm
80set 48x34x24cm 16/18kg



A9002 1 wheel 75mm
1 wheel 60mm
1 wheel 50mm
80set 56x29x20cm 16/18kg



A9003 1 wheel 50mm
1 wheel 40mm
1 wheel 25mm
120set 44x30x35cm 16/18kg



8280 1 tube 16mm
1 wheel 50mm
1 cup 50mm
26set 43x43x31cm 16/18kg



DISC BRUSHES

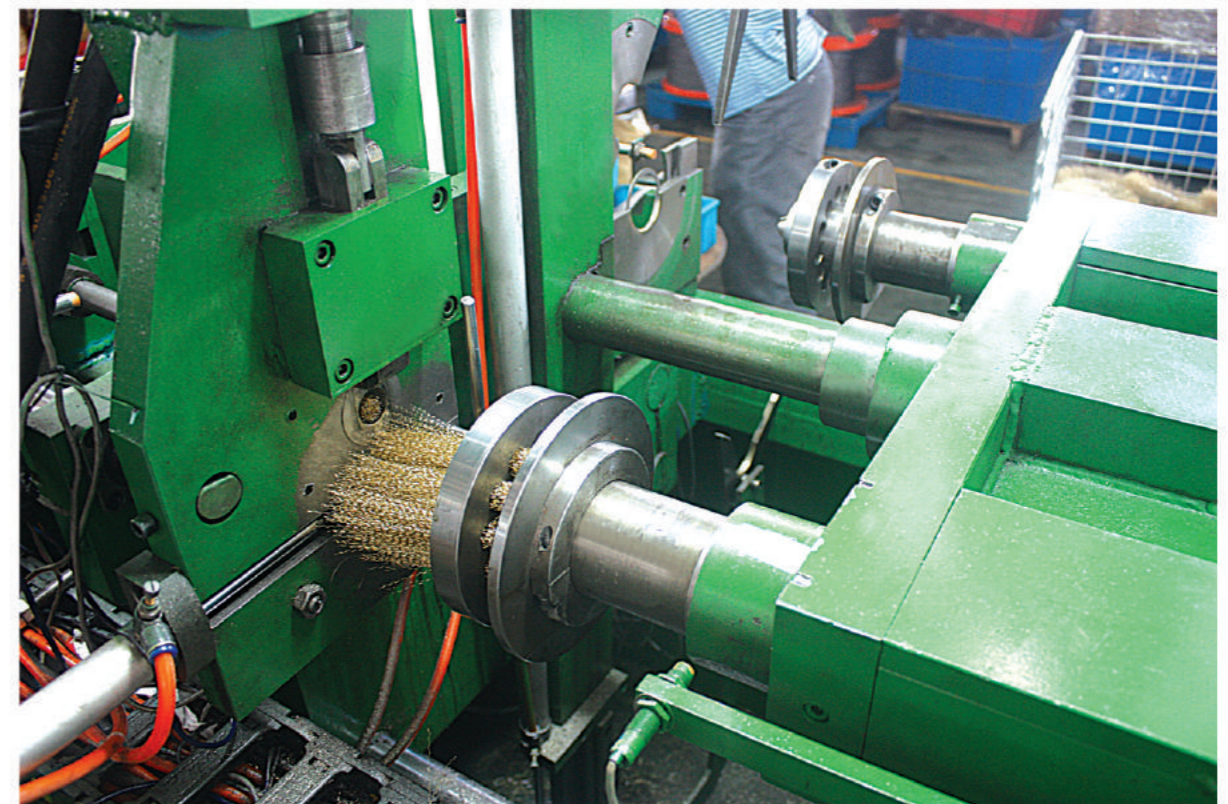

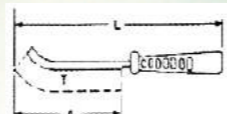

KNIFE-SHAPE PLASTIC HANDLE BRUSH

Type	Axl	Fill types	QTY.Pack	Dimension
Art No	Mm	Mm	Pcs	cm
89801	140x260	0.3brass steel	180	40x33x29
89802	140x260	0.3carbon steel	180	40x33x29
89803	140x260	PP bristle	180	40x33x29
89804	140x260	0.3zinc steel	180	40x33x29
89805	140x260	0.3stainless steel	180	40x33x29

- 1:The above listed sizes are 12pcs/inner box;and 15 inner boxes/ctn;
- 2:We also supply the type brush in showing box 24 cs/showing box,192pcs/ctn,size:52x29x39cm;
- 3:As customer request,we can also supply blister card packing for these brushes;
- 4:We supply the brush handle in different colors, such as red,green,yellow,black,orange and so on.



MINI HAND SCRATCH BRUSH WITH WIRE HANDLE

Type	Fill material	Wire size	Wire	QTY.Pack
Art.No	Mm	Mm		Pcs
M-01	Steel wire	0.20/0.30	Straight/crimp	180
M-02	Brass coated wire	0.20/0.30	straight/crimp	180
M-03	Stainless wire	0.20/0.30	straight/crimp	180
M-04	Brass wire	0.20/0.30	straight/crimp	180
M-05	PVC	0.20/0.30	straight/crimp	180



WOODEN HANDLE BRUSH

Type	Rows	QTY.Pack	Dimension
Art No		Pcs	cm
B002	2	120	46x28x26
B003	3	120	46x28x28
B004	4	120	46x28x34
B005	5	120	46x28x39
B006	6	120	46x28x42

- Filling type**
- Zinc-steel:**zinc-plated steel wire 0.33mm,straight
 - Black:**blacked steel wire 0.33mm,straight;
 - Steel:**oil-treated steel wire 0.3mm,straight;
 - Brass-steel:**brass plated steel wire 0.3mm,straight or crimped.
 - Stainless-steel:**stainless steel wire 0.3mm,straight.



PLASTIC HANDLE SCRATCH BRUSH

Type	Rows	QTY.Pack	Dimension
Art No		Pcs	cm
PI002	2	120	46x28x26
PI003	3	120	46x28x28
PI004	4	120	46x28x34
PI005	5	120	46x28x39
PI006	6	120	46x28x42

- Filling type**
- Zinc-steel:**zinc-plated steel wire 0.33mm,straight
 - Black:**blacked steel wire 0.33mm,straight;
 - Steel:**oil-treated steel wire 0.3mm,straight;
 - Brass-steel:**brass plated steel wire 0.3mm,straight or crimped.
 - Stainless-steel:**stainless steel wire 0.3mm,straight.





WOODEN HANDLE BRUSH

Type	Rows	Scraper	QTY.Pack	Dimension
Art No	mm		Pcs	cm
CH319	3x19		120	54x31x33
CH319s	3x19	scraper	72	55x25x32
CH419	4x19		120	54x31x38
Ch419s	4x19	scraper	120	55x25x38



FILE BRUSH

Art No	mm
7004	115x50
7005	75x50
7006	50x25



TUBE BRUSH

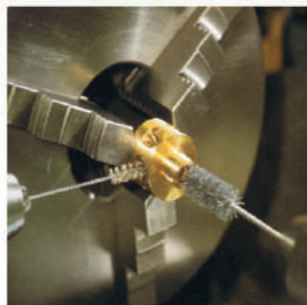
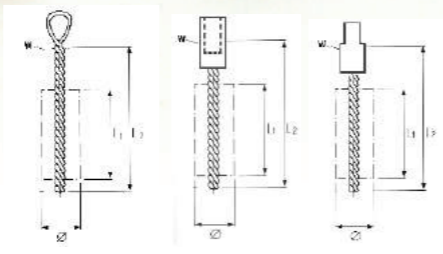

PIPE FITTING CLEANING BRUSH

Type	φ	A	L
Art No	mm	mm	mm
PF-16	16	25	160
PF-19	19	28	160
PF-23	23	32	160
PF-26	26	32	160
PF-29	29	32	160
PF-33	33	35	160
PF-42	42	38	160
PF-56	56	51	160

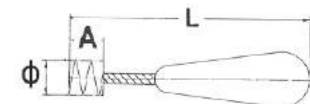

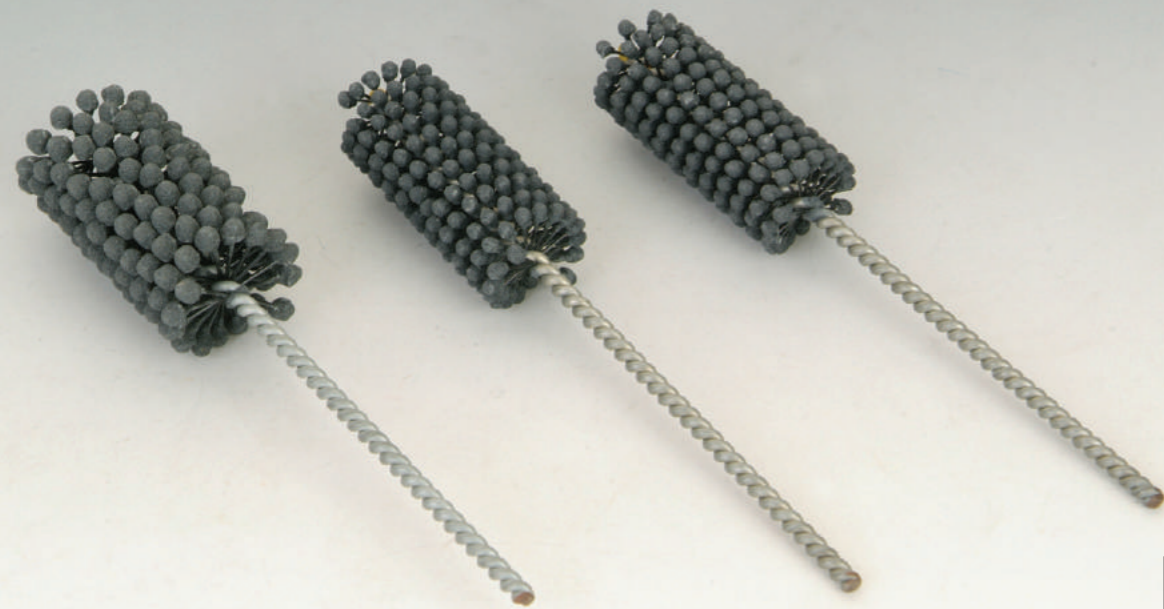

FLEX HONE

Type	φ	L1	Material
Art No	Mm	Mm	
FT-	5-105	60-70	SIC-60° SIC-120° SIC-180° SIC-240° SIC-320° SIC-600°

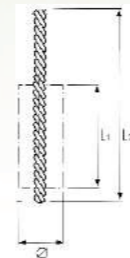

MUNIATURE BRUSHES

End brush D:5mm;6mm
 d:2.34mm;3.0mm;3.17mm
 Filling materials:
 1,Pig hair(hard) 2,Horse hair(media hard)
 3,Goat hair(soft) 4,Woolen(soft)
 5,Stainless wires(hard) 6,Brass wires(hard)
 7,Nylon wires.(hard)Filling type



MUNIATURE BRUSHES

D:12mm;16mm;19mm;21mm;25mm
 With shank d:2.34mm;3.0mm;3.17mm
 Filling materials:
 1,Pig hair(hard) 2,Horse hair(media hard)
 3,Goat hair(soft) 4,Woolen(soft)
 5,Stainless wires(hard) 6,Brass wires(hard)
 7,Nylon wires.(hard)Filling type



MUNIATURE BRUSHES

D:13mm;16mm;25mm
 d:2.34mm;3.0mm;3.17mm
 Filling materials:
 1,Pig hair(hard) 2,Horse hair(media hard)
 3,Goat hair(soft) 4,Woolen(soft)
 5,Stainless wires(hard) 6,Brass wires(hard)
 7,Nylon wires.(hard)Filling type



MUNIATURE BRUSHES

D:12mm;16mm;19mm;21mm;25mm
 d:2.34mm;3.0mm;3.17mm
 With shank
 Woolen blanket
 Coton wire



MUNIATURE BRUSHES

Wheel brushes
 Plastic core or wooden core

D	mm	50	60	60	80	80
C	mm	25	40	40	50	50
d	mm	6	6	6	6	6
Rows		2	2	2	2	2
Form		▲	▲	■	▲	■



MUNIATURE BRUSHES

D:12mm;16mm;19mm;21mm;25mm
 With shank



MULTI-PURPOSE TUBE BRUSH

Art No	
MPT-01	Inside brushes, 1/2+3/4, Outside brushes, 1/2 +3/4



BATTERY TERMINAL BRUSH

Art No	Case	Fill types
Ht601	Plastic	S-T;0.3;straight
Ht602	Metal	S-T;0.3;straight



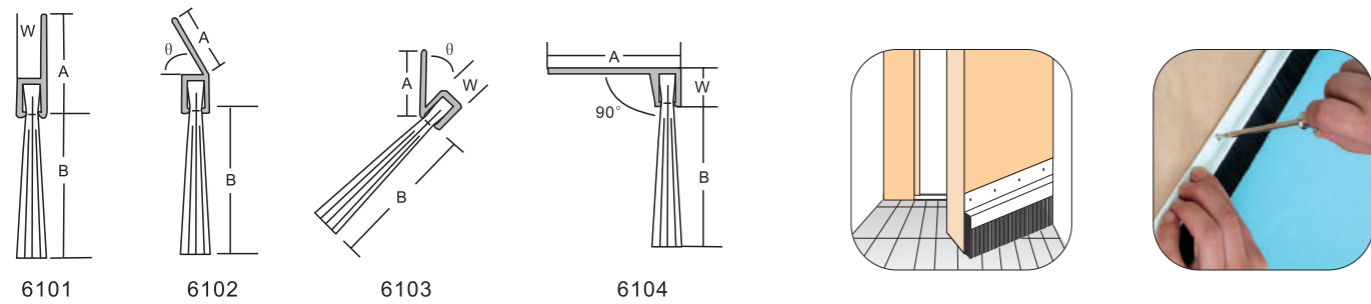
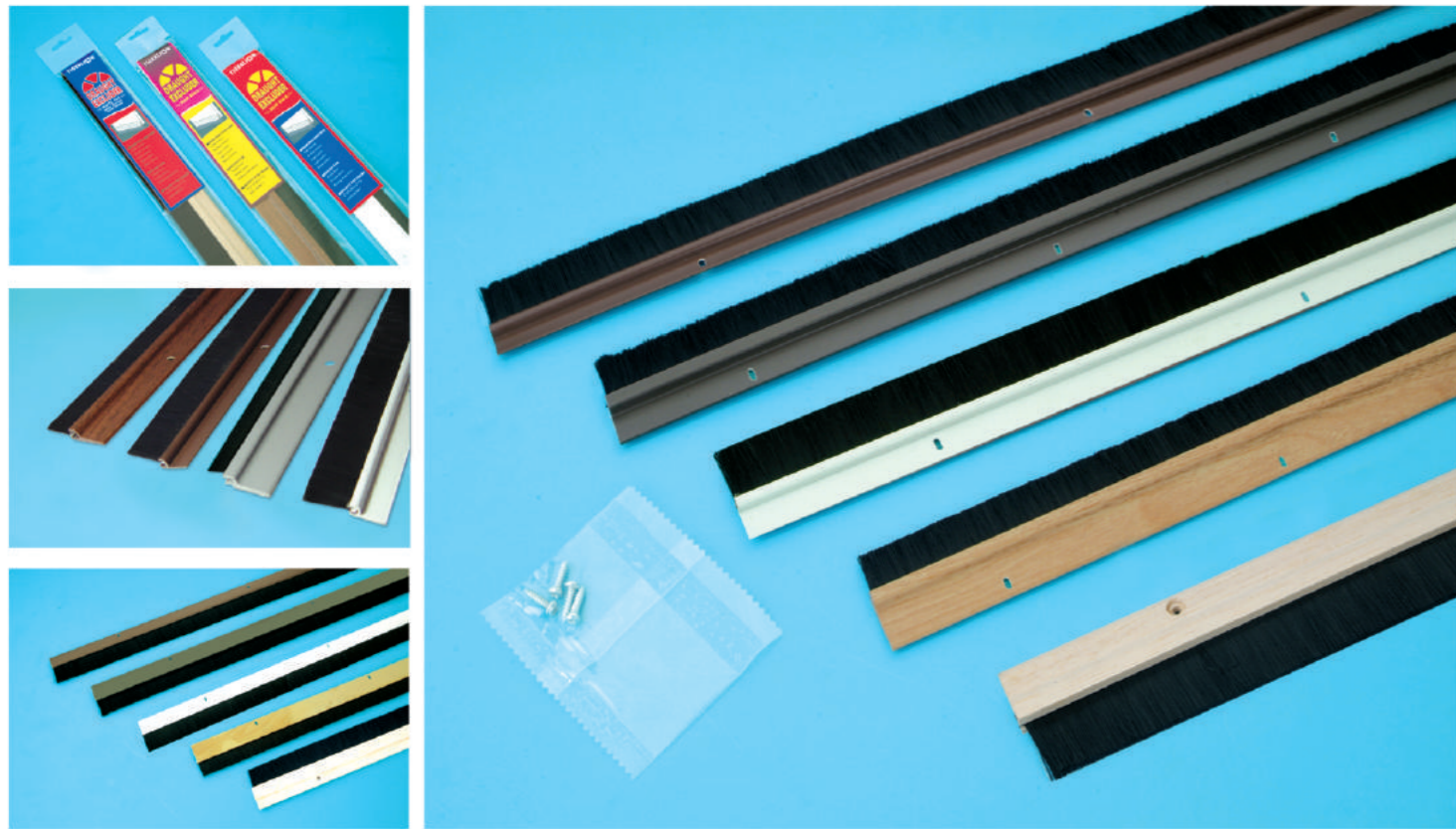

PVC HOLDER DOOR SEAL BRUSH

Screw type

ITEM NO.	A mm	B		W mm		filaments			Fitting way	PVC color available
		Standard mm	Available sizes mm			material 1	color	Dia.(mm)		
6101.0001	28	19	8-----25	12	Straight	PP	black	0.2	Holes with screws	Brown Deep dark brown Grey White Black Wooden-wave paper coating
6101.0002	20	25	8-----25	10	Straight	PP	black	0.2	Holes with screws	
6102.0001	22	19	8-----25	12	30°, 45°, 60°	PP	black	0.2	Holes with screws	
6103.0001	22	19	8-----25	12	30°, 45°, 60°	PP	black	0.2	Holes with screws	
6104.0001	28	19	8-----25	12	90°	PP	black	0.2	Holes with screws	

WOODEN HOLDER DOOR SEAL BRUSH

Screw type

6201.0001	22	19	8----25	6	straight	pp	black	0.2	Holes with screws	Original wooden color Paint in other color
-----------	----	----	---------	---	----------	----	-------	-----	-------------------	---

- PVC holder door seals with brush are designed for bottom of the doors. Suits for single doors, double doors. It is ideal for prevent air-flow, pests, noise, light from your room.
- Door seals fitting by screws, more firmly for long time. Very easy to fit on.
- If our available sizes do not fit your request, just please tell us the above drawing data A, B, W, θ and drawing numbers, we can do as you expect.
- If colors available are not what you want to have, we can also try to meet your different color request.

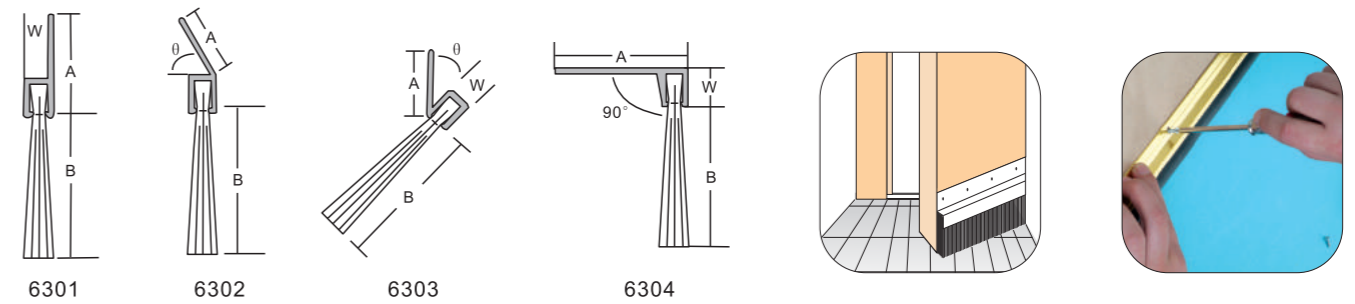
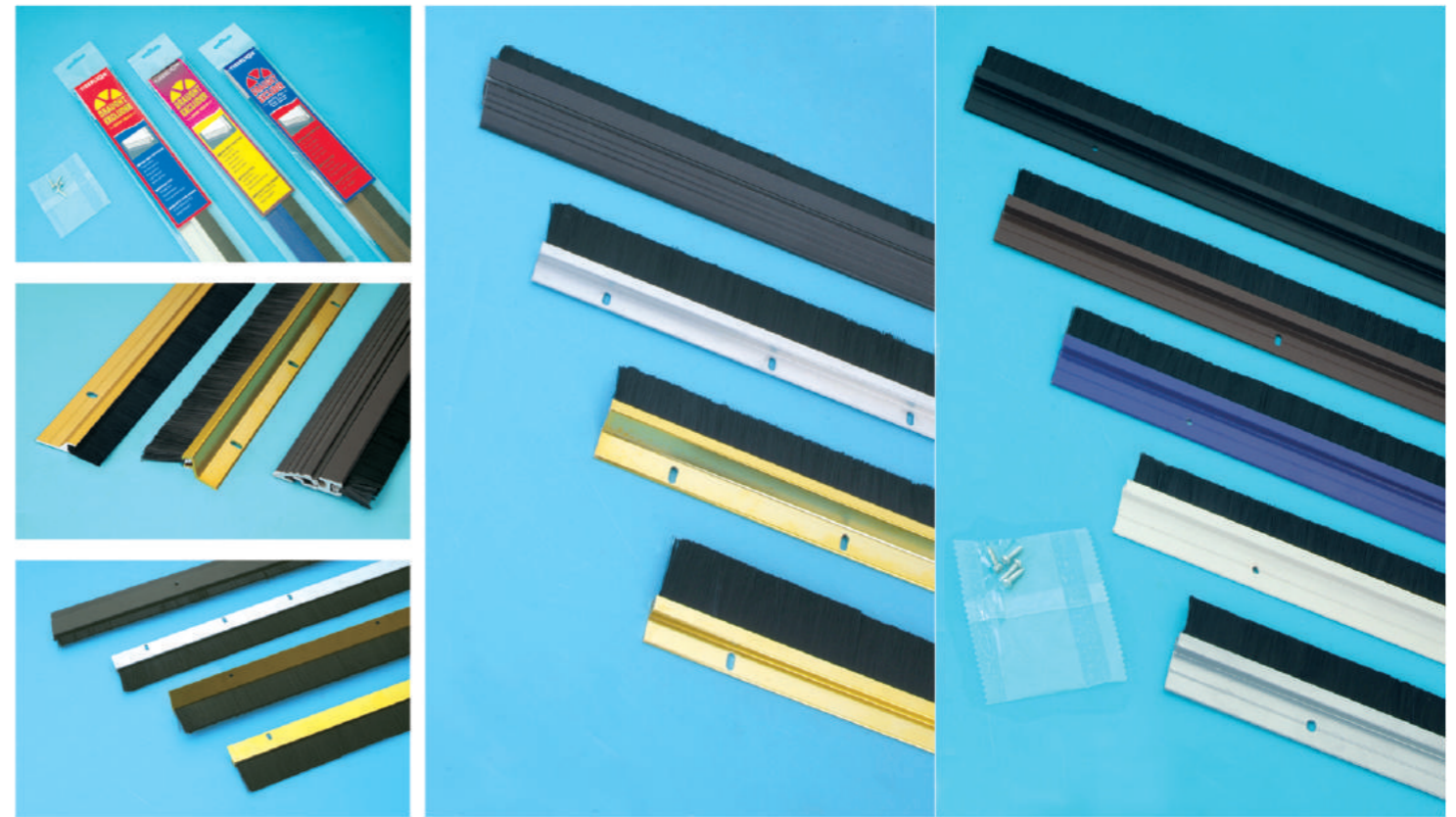

ALUMINIUM HOLDER DOOR SEAL BRUSH

Screw type

ITEM NO.	A mm	B		W mm	θ	filaments			Fitting way	Aluminium color available
		Standard mm	Available Sizes mm			Material 1	color	Dia.(mm)		
6301.0001	22	19	8-----25	12	Straight	PP	black	0.2	Holes with screws	Golden anodized White Black Sliver Brown grey
6301.0002	17	25	8-----25	10	straight	PP	black	0.2	Holes with screws	
6302.0001	22	19	8-----25	12	30°, 45°, 60°	PP	black	0.2	Holes with screws	
6303.0001	22	19	8-----25	12	30°, 45°, 60°	PP	black	0.2	Holes with screws	
6304.0001	22	19	8-----25	12	90°	PP	black	0.2	Holes with screws	

- Aluminium holder door seal brush screw type is designed for bottom of the doors, also for gaps between the door (side or top) and the wall. Suits for single doors, double doors, rolling street doors, hollow metal doors etc. It is ideal for prevent air-flow, pests, noise, light from your room.
- Door seals fitting by screws, more firmly for long time. (Tools request: Pliers, metal saw, rule, a cross screwdriver and pencil.)
- 1, Measure bottom of the door width, with pencil marked on the PVC extrusion in correct width;
- 2, Use a metal saw to short of the PVC extrusion at the length you marked with pencil;
- 3, Use pliers to cut off the brush at the same length as the PVC extrusion, press the cut edge together to avoid bristle getting off.
- 4, Clean the door bottom.
- 5, Screw to bottom of the door, adjust to perfect place, then screw firmly.
- If our available sizes do not fit your request, just please tell us the above drawing data A, B, W, θ and drawing numbers, we can do as you expect.
- If colors available are not what you want to have, we can also try to meet your different color request.

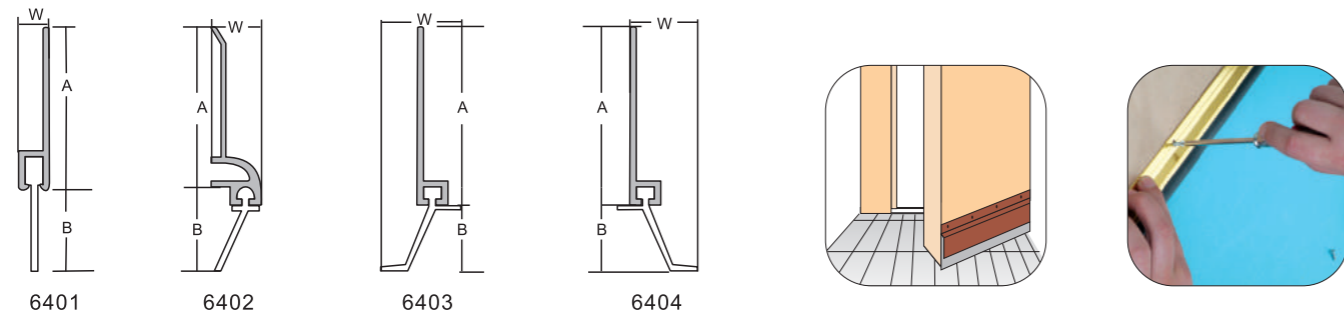
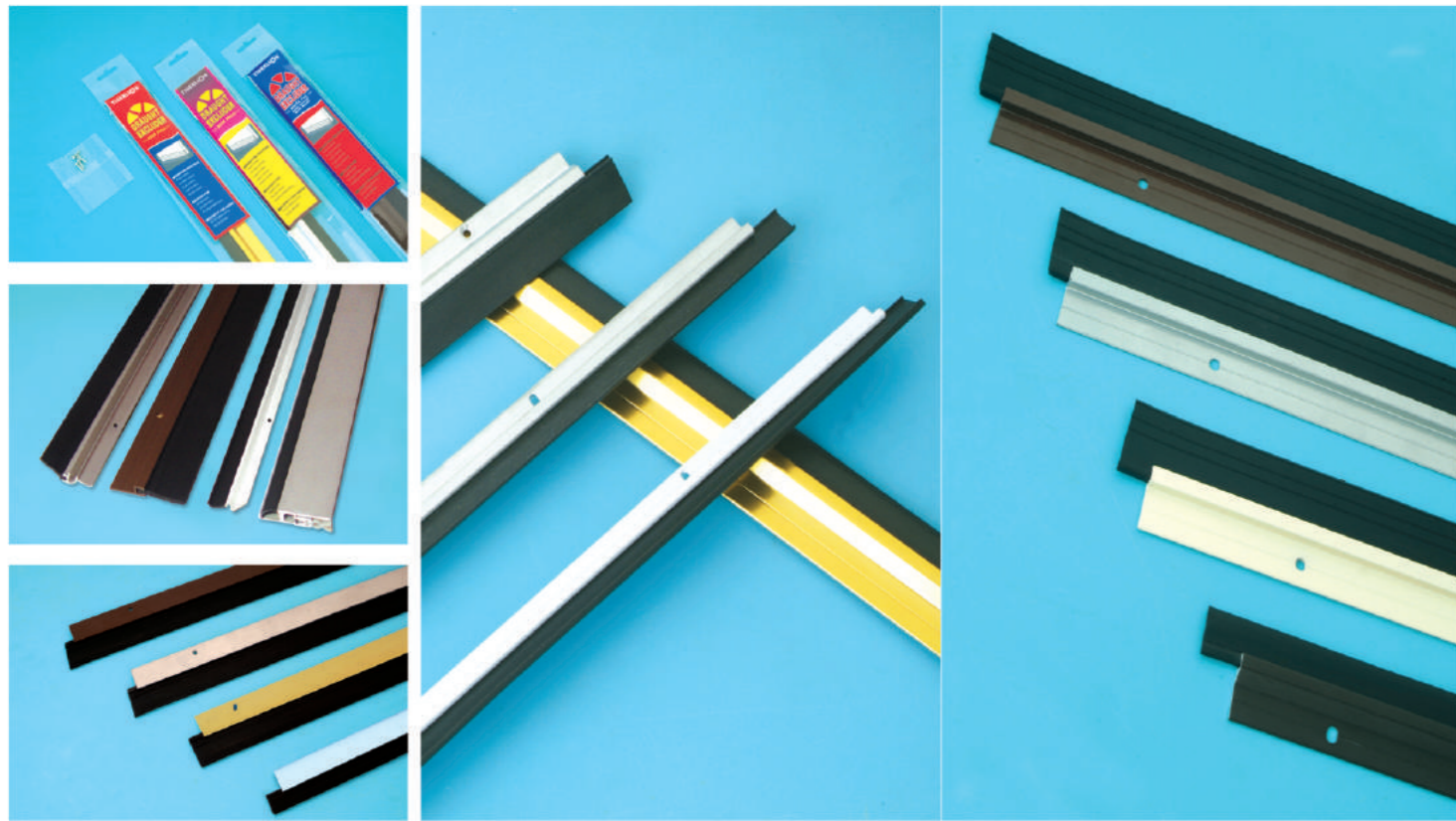

ALUMINIUM HOLDER FLEXIBLE PVC FELT

Item No.	A mm	B mm	W mm	COLOR PVC	Aluminium holder color	Fitting way
6401.0001	22	25	6	Black PVC	Golden anodized White, Black Sliver, Brown grey	Holes with screws
6402.0001	20	14	12	Black PVC		Holes with screws
6403.0001	13	12	15	Black PVC		Holes with screws
6404.0001	13	12	15	Black PVC		Holes with screws

- Aluminium holder with flexible PVC felt is designed for bottom of the doors, also for gaps between the door (side or top) and the wall. Suits for single doors, double doors, rolling street doors, hollow metal doors etc. It is ideal for prevent air-flow, pests, noise, light from your room.
- Door seals fitting by screws, more firmly for long time. Very easy to fit on:
(Tools request: Pliers, metal saw, rule, a cross screwdriver and pencil.)
- 1, Measure bottom of the door width, with pencil marked on the PVC extrusion in correct width;
- 2, Use a metal saw to short of the PVC extrusion at the length you marked with pencil;
- 3, Use pliers to cut off the brush at the same length as the PVC extrusion, press the cut edge together to avoid bristle getting off.
- 4, Clean the door bottom.
- 5, Screw to bottom of the door, adjust to perfect place, then screw firmly.
- If our available sizes do not fit your request, just please tell us the above drawing data A,B,W, and drawing numbers, we can do as you expect.
- If colors available are not what you want to have, we can also try to meet your different color request.

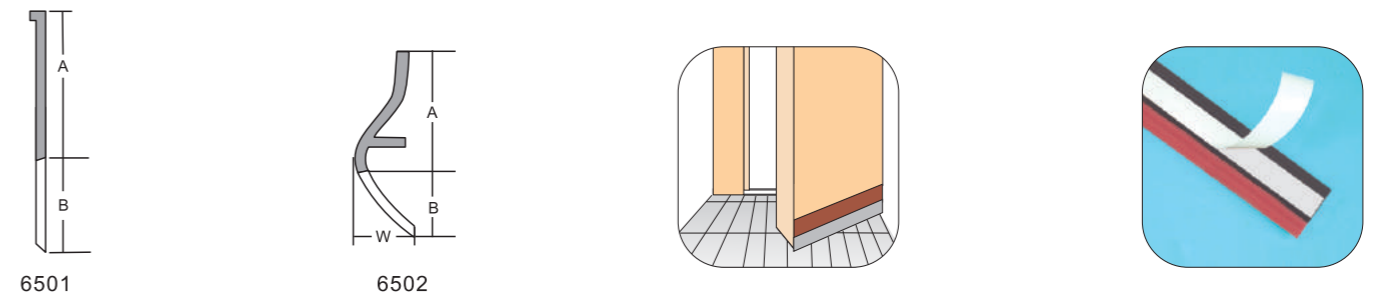
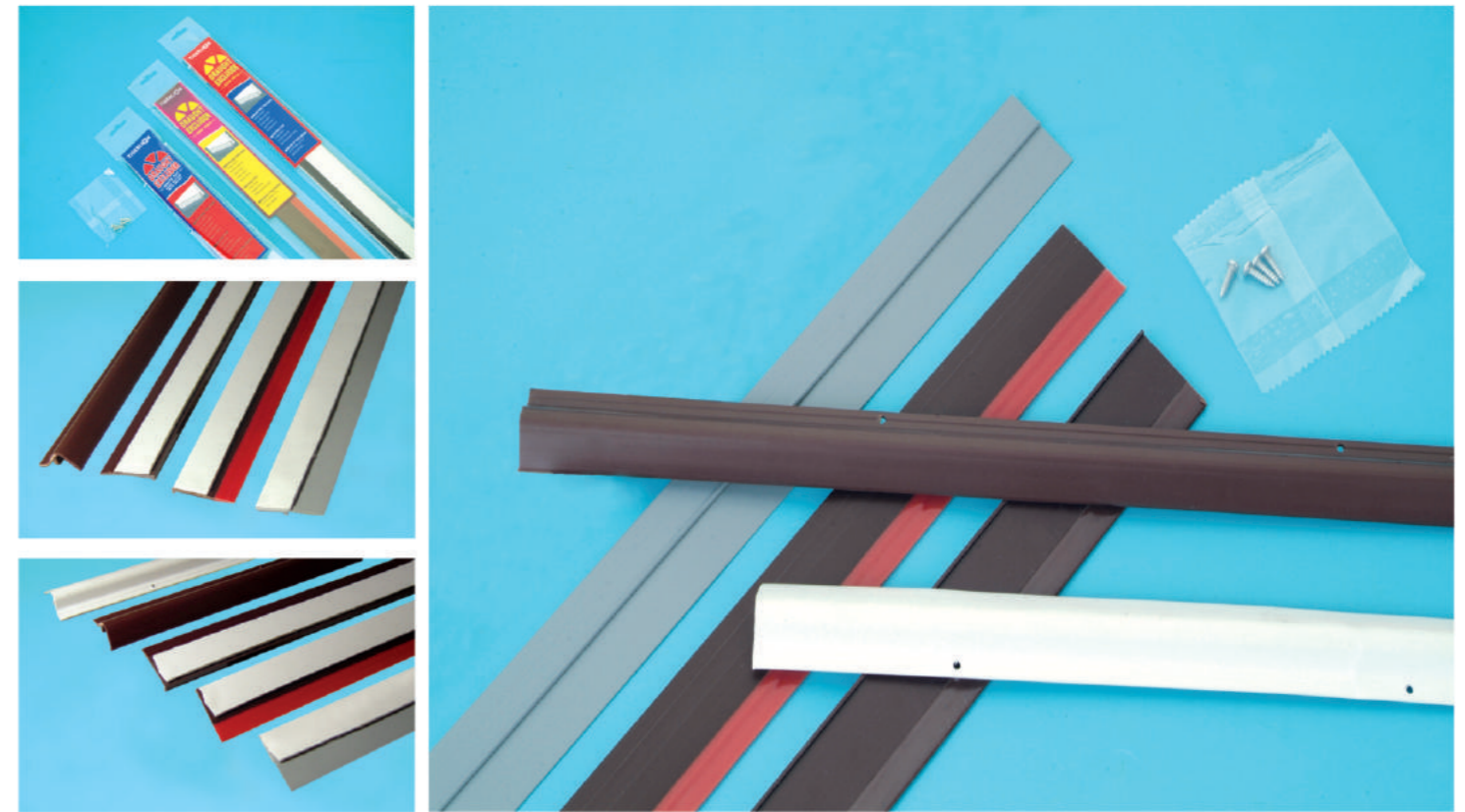

**FLEXIBLE PVC FELT
STICKER TYPE**

ITEM NO.	A mm	B mm	W mm	θ	Fitting way	PVC color available
6501.0001	24	11		Straight	Double stickers	Brown, black, white,
6502.0001	18	27	12		Holes with nails	

- Flexible PVC felt is designed for bottom of the doors. Suits for single doors, double doors. It is ideal for prevent air-flow, pests, noise, light from your room.
- The PVC felt with double stickers, more quick and easy to fit on. (Tools request: Pliers, metal saw, rule and pencil.)
- If our available sizes do not fit your request, just please tell us the above drawing data A,B,W, θ and drawing numbers, we can do as you expect.